

imageRUNNER C1530 Series

FAST AND SECURE COLOUR A4 DEVICES FOR ALL YOUR PRINTING AND SCANNING NEEDS

MAIN CONFIGURATION OPTIONS

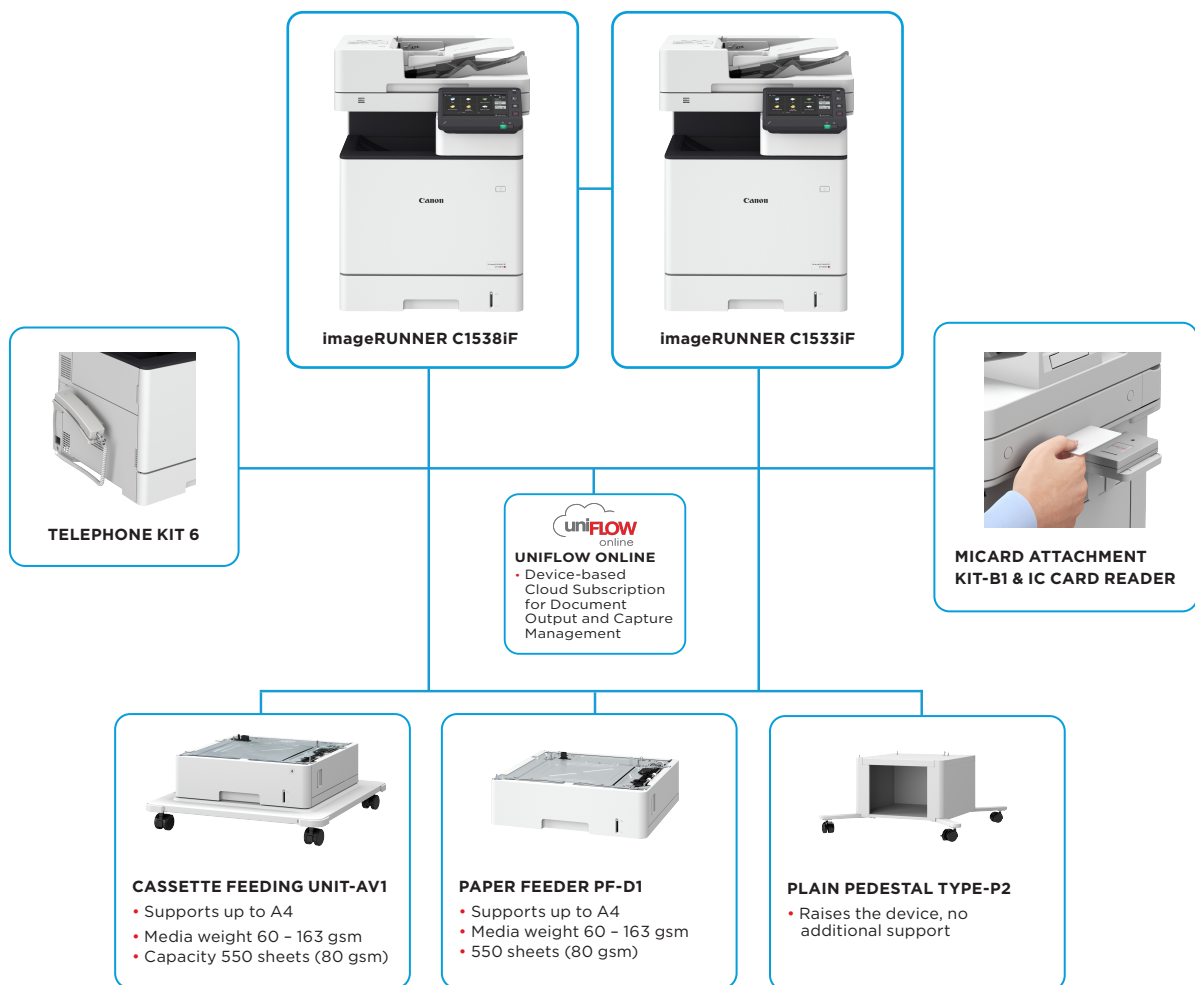

This flat configuration is for illustration purpose only. For a complete list of options and the exact compatibility relationships, please refer to the [online product configurator](#)

TECHNICAL SPECIFICATIONS

imageRUNNER C1530 Series

MAIN UNIT		Operating System	UFR II: Windows® 8.1/10/Server 2012/Server 2012 R2/Server 2016/Server 2019, MAC OS X (10.11 or later) PCL: Windows® 8.1/10/Server 2012/Server 2012 R2/Server 2016/Server 2019 PS: Windows® 8.1/10/Server 2012/Server 2012 R2/Server 2016/Server 2019, MAC OS X (10.10 or later) PPD: Windows® 8.1/10, MAC OS X (10.10 or later) As of January, 2021
Machine type	A4 Colour Laser Multifunctional	COPY SPECIFICATIONS	
Core functions	Print, Copy, Scan, Send and Fax	Copy Speed (BW/CL)	iR C1538iF: Up to 38/38 ppm (A4R) Up to 40/40 ppm (A5R), Up to 59/59 ppm (A5) iR C1533iF: Up to 33/33 ppm (A4R) Up to 40/40 ppm (A5R), Up to 55/55 ppm (A5) Approx. 5.9/6.9 seconds or less
Processor	1GHz Dual Core Processor	First-Copy-Out Time (A4, BW/CL)	Approx. 5.9/6.9 seconds or less
Control Panel	17.8 cm/7 inch TFT LCD WVGA Colour Touch panel	Copy resolution (dpi)	600 x 600
Memory	Standard: 2.0GB RAM	Multiple Copies	Up to 999 copies
Storage	Standard: 64GB eMMC (available space 30GB)	Copy Density	Automatic or Manual (9 Levels)
Interface Connection	NETWORK Standard: 1000Base-T/100Base-TX/10Base-T, Wireless LAN (IEEE 802.11 b/g/n) OTHERS Standard: USB 2.0 (Host) x2, USB 2.0 (Device) x1	Magnification	25% to 400% (1% Increments) Preset reduction/enlargement: 25%, 50%, 70%, 100%, 141%, 200%, 400%
Paper Supply Capacity (A4, 80gsm)	Standard: 650 sheets Maximum: 2300 sheets (with Cassette Feeding Unit-AV1 + Paper Feeder PF-D1 x 2)	Copy Features	Preset R/E Ratios by Area, Two-Sided, Density Adjustment, Original Type Selection, Interrupt Mode, Two-sided Original, Sort, Job Build, N on 1, Sharpness, Erase Frame, Copy ID Card, Skip Blank Pages, Colour Mode, Reserved copy, Copy Sample
Paper output capacity (A4, 80gsm)	Standard: 200 sheets Maximum: 200 sheets	SCAN SPECIFICATIONS	
Finishing Capabilities	Collate, Group	Type	Standard: Single-pass Duplexing Automatic Document Feeder (2-sided to 2-sided) up to 100 sheets
Supported Media Types	Multi-purpose Tray: Thin, Plain, Recycled, Colour, Heavy, Bond, Transparency, Label, Pre-punched, Envelope Paper Cassette: Plain, Recycled, Colour, Pre-punched	Document Feeder Paper Capacity (80 gsm)	Platen: Sheet, Book Document Feeder media weight : 1-sided scanning: 42 to 128 gsm (BW), 64 to 128 gsm (CL) 2-sided scanning: 50 to 128 gsm (BW), 64 to 128 gsm (CL)
Supported Media Sizes	Multi-purpose tray: Standard size: A4R, A5, A5R, A6R, B5R, Envelopes [No. 10(COM 10), Monarch, ISO-C5, DL] Custom Size/Free Size: Min.76.2 x127.0 mm up to 216.0 x355.6 mm Paper Cassette: Standard size: A4R, A5, A5R, A6R, B5R	Acceptable Originals and weights	Platen: max. scanning size: 216.0 x 355.6 mm Document Feeder media size: A4R, A5R, A6R, B5R Custom size: 48.0 x128.0 mm to 216.0 x 355.6 mm
Supported Media Weights	Multi-purpose tray: 60 to 216 gsm Paper Cassettes: 60 to 163 gsm Duplex: 60 to 163 gsm	Supported media sizes	DADF: 1-sided Scanning: 95/95 (300 dpi, send), 50/50 (600 dpi, copy) 2-sided Scanning: 150/145 (300 dpi, send), 50/50 (600 dpi, copy) Scan for Copy: up to 600 x 600 Scan for Send: (Push,BW) up to 600 x 600, (Pull,BW) up to 600 x 600 (Push,CL) up to 300 x 300, (Pull,CL) up to 300 x 300 Scan for Fax: up to 600 x 600
Warm-up Time	4 Seconds or Less* * Time from device power-on to when key operations can be performed on the touch panel display. From Sleep Mode: 10 seconds or less 12 Seconds or Less* *Time from device power on, until copy ready (not print reservation)	Scan Speed (ipm: BW/CL, A4)	Scan Resolution (dpi) Scan for Copy: up to 600 x 600 Scan for Send: (Push,BW) up to 600 x 600, (Pull,BW) up to 600 x 600 (Push,CL) up to 300 x 300, (Pull,CL) up to 300 x 300 Scan for Fax: up to 600 x 600
Dimensions (W x D x H)	500 x 556 x 640 mm	Pull Scan Specifications	Colour Network ScanGear2. For both TWAIN and WIA Supported OS: Windows®7/8.1/10/Server2008/Server2008 R2/Server2012/Server2012 R2/Server 2016/Server 2019
Installation Space (W x D)	717 x 785 mm (with Multipurpose Tray extended and Cassette door open)	Scan Method	PushScan, PullScan, Scan to Network, Scan to USB Memory Key, Scan to Mobile device, Scan to cloud (uniFLOW Online/Online Express)
Weight	Approx. 41.0 kg including toner		
PRINT SPECIFICATIONS			
Print Speed (BW/CL)	iR C1538iF: Up to 38/38 ppm (A4R) Up to 40/40 ppm (A5R),Up to 59/59 ppm (A5) iR C1533iF: Up to 33/33 ppm (A4R) Up to 40/40 ppm (A5R), Up to 55/55 ppm (A5)		
Print Resolution (dpi)	Up to 1,200 x 1,200		
Page description languages	Standard: UFR II, PCL6, Adobe® PostScript®3™		
Direct Print	Supported file types: RUI: PDF, EPS, TIFF/JPEG, XPS USB Memory: PDF, TIFF/JPEG, XPS Network Place: PDF, TIFF/JPEG, XPS AirPrint, Mopria, Universal Print by Microsoft		
Printing from mobile and cloud	AirPrint, Mopria, Canon PRINT Business and uniFLOW Online A range of software solutions is available to provide printing from mobile devices and cloud-based services depending on your requirements. Please contact your sales representative for further information		
Fonts	PS fonts: 136 Roman PCL fonts: 93 Roman, 10 Bitmap fonts, 2 OCR fonts, Andalé Mono WT J/K/S/T*1 (Japanese, Korean, Simplified and Traditional Chinese) , Barcode fonts*2 *1 Requires optional PCL International Font Set-A1 *2 Requires optional Barcode Printing Kit-D1		
Print Features	Secure Print, Watermark, Header/Footer, Page Layout, Two-sided Printing, Mixed Paper Sizes/ Orientations, Toner Reduction, Poster Printing, Forced Hold Printing, Print Date, Scheduled Printing, Printing Using a Virtual Printer		

TECHNICAL SPECIFICATIONS

imageRUNNER C1530 Series

SEND SPECIFICATIONS

Destination	Standard: E-mail/Internet FAX (SMTP), Super G3 FAX, SMB3.0, FTP, WebDAV
Address Book	LDAP (2,000)/Local (1,600)/Speed dial (200)
Send resolution (dpi)	Push: 100 x 100, 150 x 150, 200 x 100 (Normal), 200 x 200 (Fine), 200 x 400* (SuperFine), 300 x 300, 400 x 400* (UltraFine), 600 x 600* Pull: 75 x 75, 100 x 100, 150 x 150, 200 x 200, 300 x 300, 400 x 400*, 600 x 600* *Colour mode is black and white only
Communication protocol	File: FTP (TCP/IP), SMB3.0 (TCP/IP), WebDAV Email/iFax: SMTP (send), POP3 (receive)
File Format	Standard: TIFF (MMR), JPEG*, PDF (Compact, Searchable, PDF/A-1b, Encrypted), XPS (Compact, Searchable), PDF/XPS (Device Signature, Office Open XML (PowerPoint, Word)) Optional: PDF (Trace & Smooth), PDF/XPS (User Signature) *Single page only
Universal Send Features	Original Type Selection, Two-sided Original, Density Adjustment, Sharpness, Erase Frame, Job Build, Delayed Send, Preview, Job Done Notice, File Name, Subject/Message, Reply-to, E-mail Priority, TX Report, Original Content Orientation

FAX SPECIFICATIONS

Maximum Number of Connection Lines	1
Modem Speed	Super G3: 33.6 kbps G3: 14.4 kbps
Compression Method	MH, MR, MMR, JBIG
Resolution (dpi)	400 x 400 (Ultrafine), 200 x 400 (Superfine), 200 x 200 (Fine), 200 x 100 (Normal)
Sending/Recording Size	Sending: A4, A5*1, A6*1, B5*1 Receiving: A4, A5, B5 *1 Sent as A4
FAX memory	Up to 30,000 pages
Speed dials	Max. 200
Group dials/destinations	Max. 199 dials
Sequential broadcast	Max. 256 addresses
Memory backup	Yes
Fax Features	Sender's Name (TTI), Direct Send, Delayed Send, Preview, Job Done Notice, TX Report, Interrupt Transmission, Sequential Broadcasting, Password/Subaddress Sending, Confidential Mailbox

STORE SPECIFICATION

Memory Media	Standard: USB Memory
---------------------	----------------------

SECURITY SPECIFICATIONS

Authentication and Access Control	User Authentication (Picture Login, Picture and PIN Login, Username and Password Login, Function Level Login, Mobile Login), Department ID Authentication (Department ID and PIN Login, Function Level Login), uniFLOW Online Express (PIN Login, Picture Login, Picture and PIN Login, Card Login, Card and PIN Login, Username and Password Login, Department ID and PIN Login, Function Level Login), Access Management System (Access Control)
--	--

Document Security	Print Security (Secure Print, Encrypted SecurePrint, Forced Hold Printing, uniFLOW Secure Print*1), Recieve Data Security (Confidential Fax Inbox Forwarding Received Documents Automatically), Scan Security (Encrypted PDF, Device Signature PDF/XPS, User Signature PDF/XPS*2), Send Data Security (Setting for requesting password input per transmission, Restricted E-mail/File send functions, Confirming FAX number, Allow/Restrict Fax Driver Transmissions, Allow/Restrict Sending from History, S/MIME Support),
--------------------------	---

*1 Requires optional uniFLOW Online / uniFLOW
*2 Requires optional Universal Send Digital User Signature Kit-C1

Network Security

TLS 1.3, IPsec, IEEE802.1X authentication, SNMP V3.0, Firewall Functionality (IP/MAC Address Filtering), Dual Network Support (Wired LAN/Wireless LAN, Wired LAN/Wired LAN), Disabling/Enabling (Network Protocols/Applications, Remote UI, USB Interface), G3 FAX separation from LAN, USB Port separation from LAN, Scan and Send -Virus Concerns for E-mail Reception

Device Security

Standard Storage Initialize, Job Log Conceal Function, Protecting MFP Software Integrity, Verify System at Startup, Runtime Intrusion Detection

Device Management and Auditing

Administrator Password, Digital Certificate and Key Management, Audit Log, Cooperating with External Security Audit System (Security Information and Event Management), Security Policy Setting

ENVIRONMENTAL SPECIFICATIONS

Operating Environment

Temperature: 10 to 30 °C
Humidity: 20 to 80% RH (Relative Humidity)

Power source

iR C1538iF: 220-240V 50/60Hz 4.0A
iR C1533iF: 220-240V 50/60Hz 3.9A

Power consumption

Maximum: Approx. 1,500 W
Standby: Approx. 33.3 W*1
Sleep mode: Approx. 1.1 W*2

*1 Reference value: measured one unit

*2 Sleep mode is not available in all circumstances due to certain settings.

Typical Electricity Consumption (TEC)* :

iR C1538iF : 0.43 kWh

iR C1533iF : 0.40 kWh

*As per US ENERGY STAR version 3.0

Sound Power Level (LWA,m)
Active (1-sided): 6.1B*1, Kv 0.3B*1

*1 Reference value: measured only one unit with ISO7779, described with ISO9296:2017

Sound Pressure Level (LpAm)

Bystander's position:

Active (1-sided): 50 dB*1

*1 Reference value: measured only one unit with ISO7779, described with ISO9296:2017

Noise levels (BW/CL)

Standards

Blue Angel (applied for)

CONSUMABLES

Toner Cartridge/s

T10 TONER BK/C/M/Y
T10L TONER BK/C/M/Y

Toner Yield (Estimated @ 5% Coverage)

T10 TONER BK: 13,000 pages
T10 TONER C/M/Y: 10,000 pages
T10L TONER BK: 6,000 pages
T10L TONER C/M/Y: 5,000 pages

SOFTWARE AND PRINTER MANAGEMENT

Tracking and reporting

uniFLOW Online Express

Remote management tools

iW Enterprise Management Console
eMaintenance
Content Delivery System

Scanning software

Network ScanGear

TECHNICAL SPECIFICATIONS

imageRUNNER C1530 Series

PAPER SUPPLY OPTIONS

CASSETTE FEEDING UNIT-AV1

Paper Capacity: 550 sheets (80 gsm)
Paper Type: Thin, Plain, Heavy, Recycled, Colour, Pre-punched, Bond, Labels
Paper Size: A4R, A5, A5R, A6R, B5R
Custom Size: 101.6 × 148.0 mm to 216.0 × 355.6 mm
Paper Weight: 60 to 163 gsm
Dimensions (W x D x H): 597 x 635 x 225 mm
Weight: Approx. 15.5 kg

Paper Feeder PF-D1

Paper Capacity: 550 sheets (80 gsm)
Paper Type: Thin, Plain, Heavy, Recycled, Colour, Pre-punched, Bond, Labels
Paper Size: A4R, A5, A5R, A6R, B5R
Custom Size: 101.6 × 148.0 mm to 216.0 × 355.6 mm
Paper Weight: 60 to 163 gsm
Dimensions (W x D x H): 458 x 464 x 130 mm
Weight: Approx. 6.1 kg

HARDWARE ACCESSORIES

CARD READERS

Copy Card Reader Attachment-J1
Copy Card Reader-F1

OTHERS

MiCARD Attachment Kit-B1

SYSTEM AND CONTROLLER OPTIONS

PRINT ACCESSORIES

PCL International Font Set-A1.

SEND OPTIONS

Universal Send Trace & Smooth PDF Kit-A1
Universal Send Digital User Signature Kit-C1

Barcode Printing

Barcode Printing Kit-D1

System Accessories

Copy Control Interface Kit-C1

OTHER OPTIONS

ACCESSIBILITY

ADF Access Handle-A1

ACCESSORIES

TELEPHONE 6 KIT Long cord Cool White

Software & Solutions



Compatibility



Canon Inc.
canon.com

Canon Europe
canon-europe.com

English edition

© Canon Europa N.V., 2021